



First Look, First Shot, First Kill!

F/A-22 

STATUS OF F/A-22

FULL SCALE FATIGUE TEST

30 Nov – 2 Dec

2004 USAF ASIP Conference

Memphis, Tennessee

Shery Welsh, Lead DADT Engineer

F/A-22 Structures

Acknowledgements:

Lockheed Martin Aeronautics Company

Dr. Thomas Brussat

Full-Scale Durability Test Team, Lockheed Martin Aeronautics Co.

Dr. Ji Eun Park

Skip Ellsworth

Robert Dallas

Nate Iszler

Keith Keene

The Boeing Company

Michael McMaster





Outline



First Look, First Shot, First Kill!

F/A-22



- Test Article Configuration
- Non-Destructive Inspection Process
- Major Cracking Events
- Repairs & Downtime
- Test Anomaly Report Process
- Redesigns
- Test Completion
- Conclusion



F/A-22 Fatigue Test Article Configuration



First Look, First Shot, First Kill!

F/A-22



- **Structurally complete airframe**

- Forward, center & aft fuselage
- Wings, leading edge flaps, flaperons, & ailerons
- Vertical stabilizers & rudders

Boeing-Seattle
 - Aft Fuselage
 - Wing

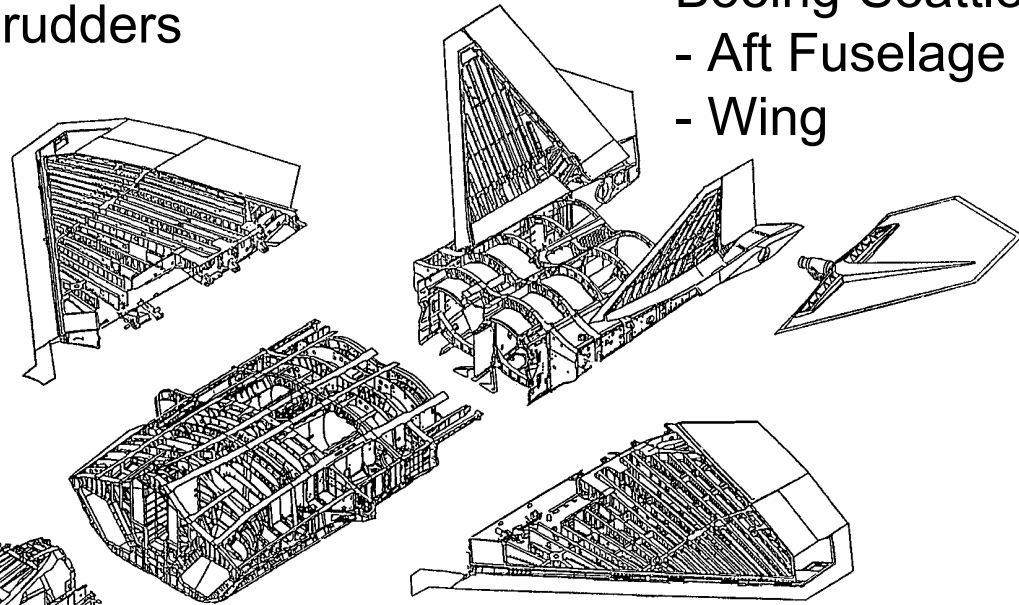

LM Aero-Marietta
 - Fwd Fuselage
 - Empennage
 - Control Surfaces

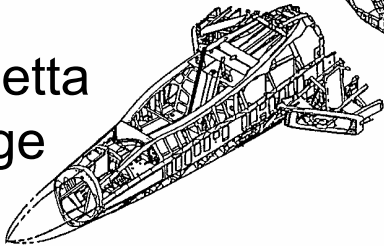

LM Aero-Fort Worth
 - Mid Fuselage



NDI Inspection Process



First Look, First Shot, First Kill!

F/A-22



- Extensive test article inspections every 800-1000 flt hrs
 - Visual, eddie-current, ultrasonic, fluorescent-penetrant, borescope
 - Daily & weekly inspections as well
- Engineers trained as “screeners”
 - DaDT engineers intimately familiar with structure
 - Familiarity with analysis resulted in a more thorough inspection of the area and not just inspection location
 - Screeners immediately available; NDI personnel had to be scheduled
- On-site support from Lockheed Martin Fort Worth and The Boeing Company in Seattle
 - Decision making on-the-spot
 - Communicated larger/complicated issues to homeland site in real time
 - Rapid repairs



Strain Gage Data



First Look, First Shot, First Kill!

F/A-22 

- **Approximately 1500 strain gages, 65 load bridges & 25 deflection gages installed on test article**
- **Throughout test, strain gage data reviewed “live” daily/weekly**
- **A couple of catastrophic failures & other general cracking events were avoided due to alerts from primary data reviewer**
 - **LHS Forward Boom Frame 2**
 - **RHS MWB Hinge Fitting at FS583**
 - **LHS MWB Actuator**
 - **RHS Forward Boom FS 681 Frame 3**
 - **LHS Forward Boom FS 708 Frame 4**
 - **LHS Forward Boom FS 681 Frame 3 Lower Web**
 - **Inboard Rear Spar**



Strain Gage Review



First Look, First Shot, First Kill!

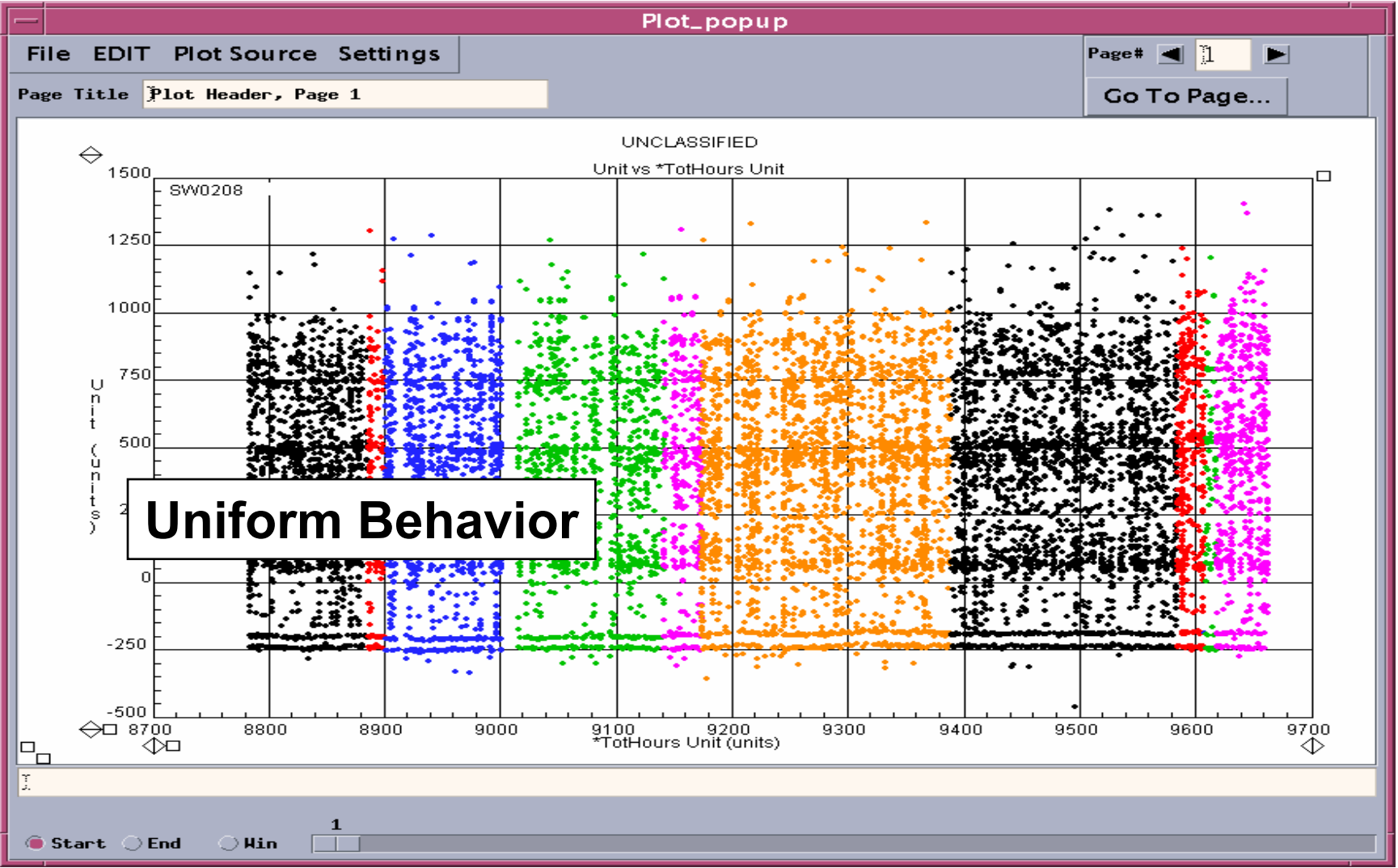



LHS Forward Boom Frame 2



First Look, First Shot, First Kill!

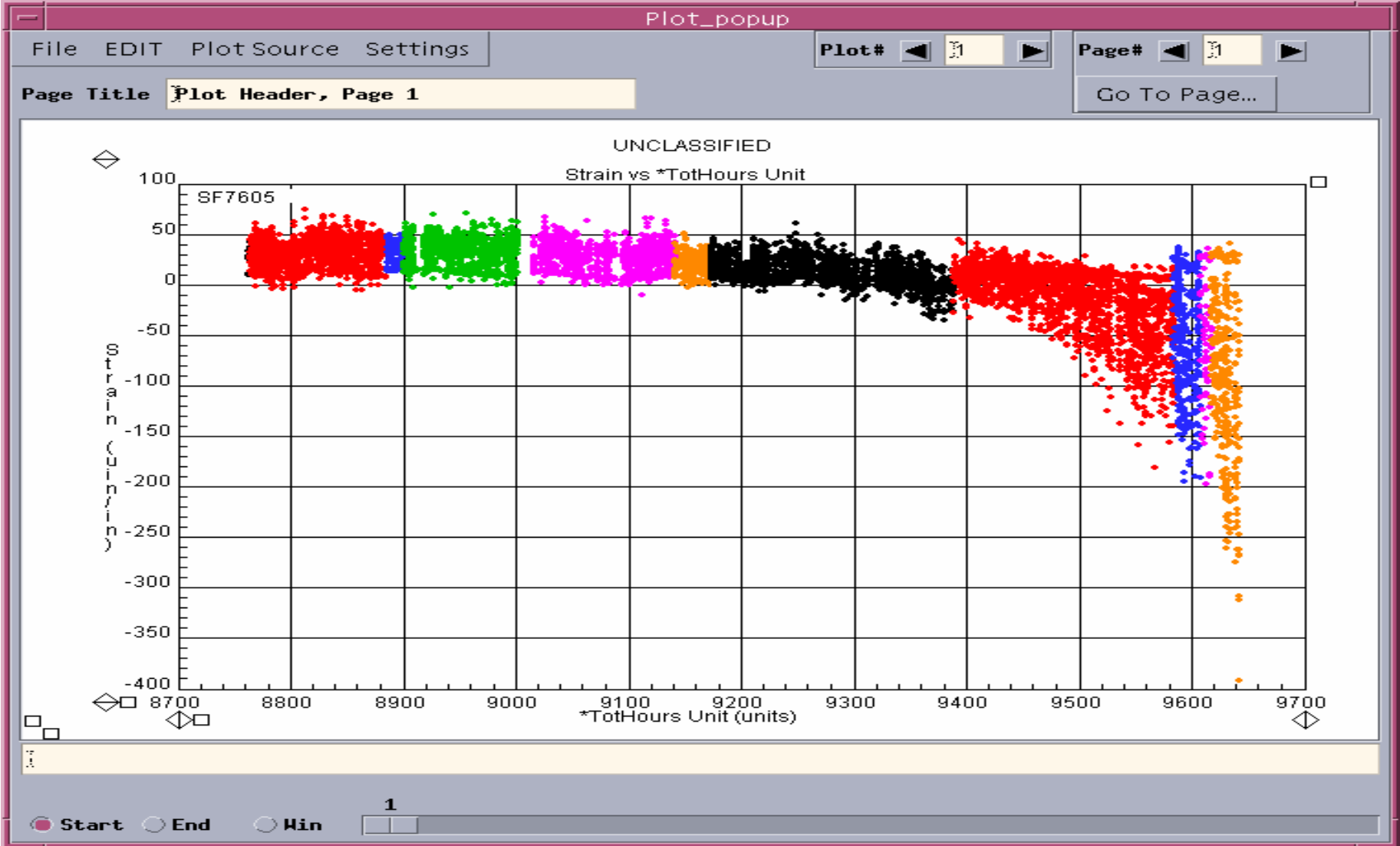
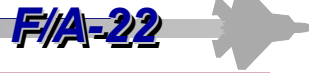



First Look. First Shot. First Kill!

F/A-22

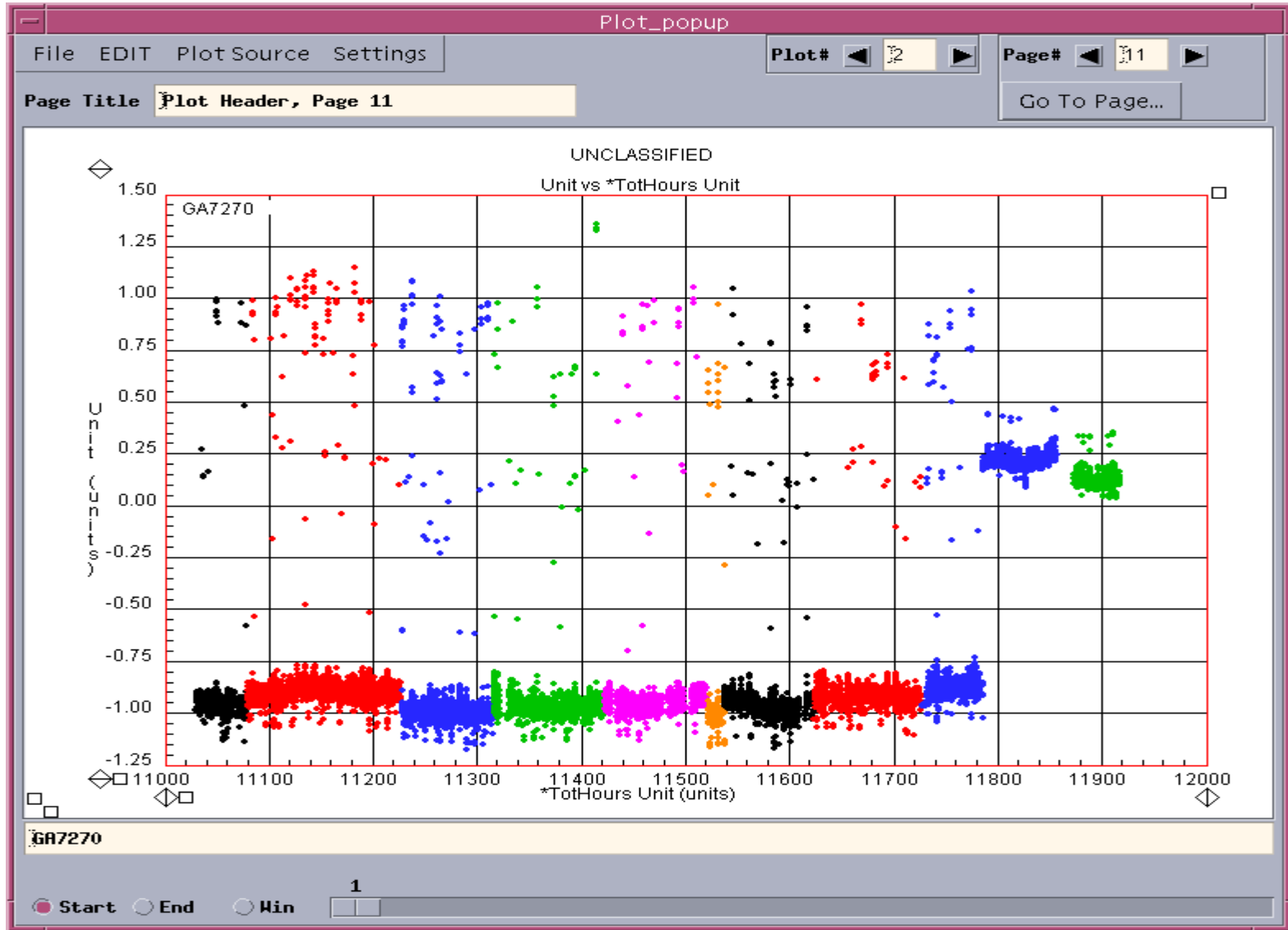



LHS Forward Boom Frame 2



First Look, First Shot, First Kill!

F/A-22

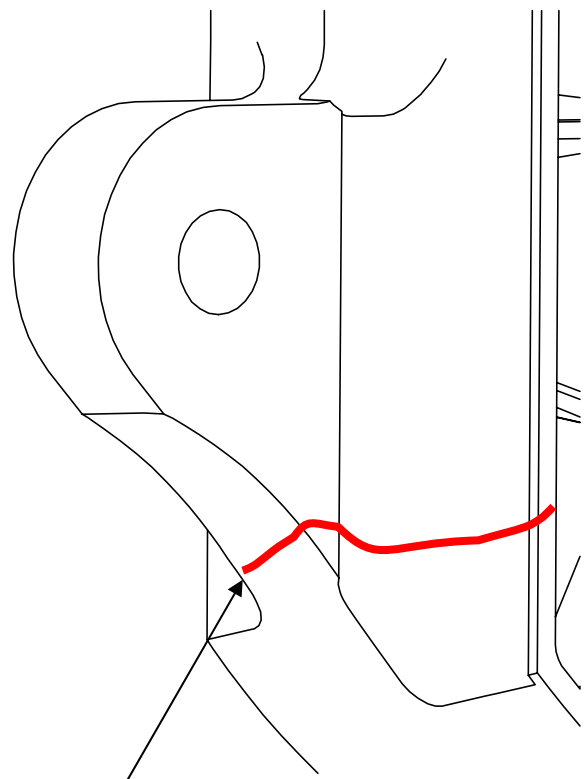
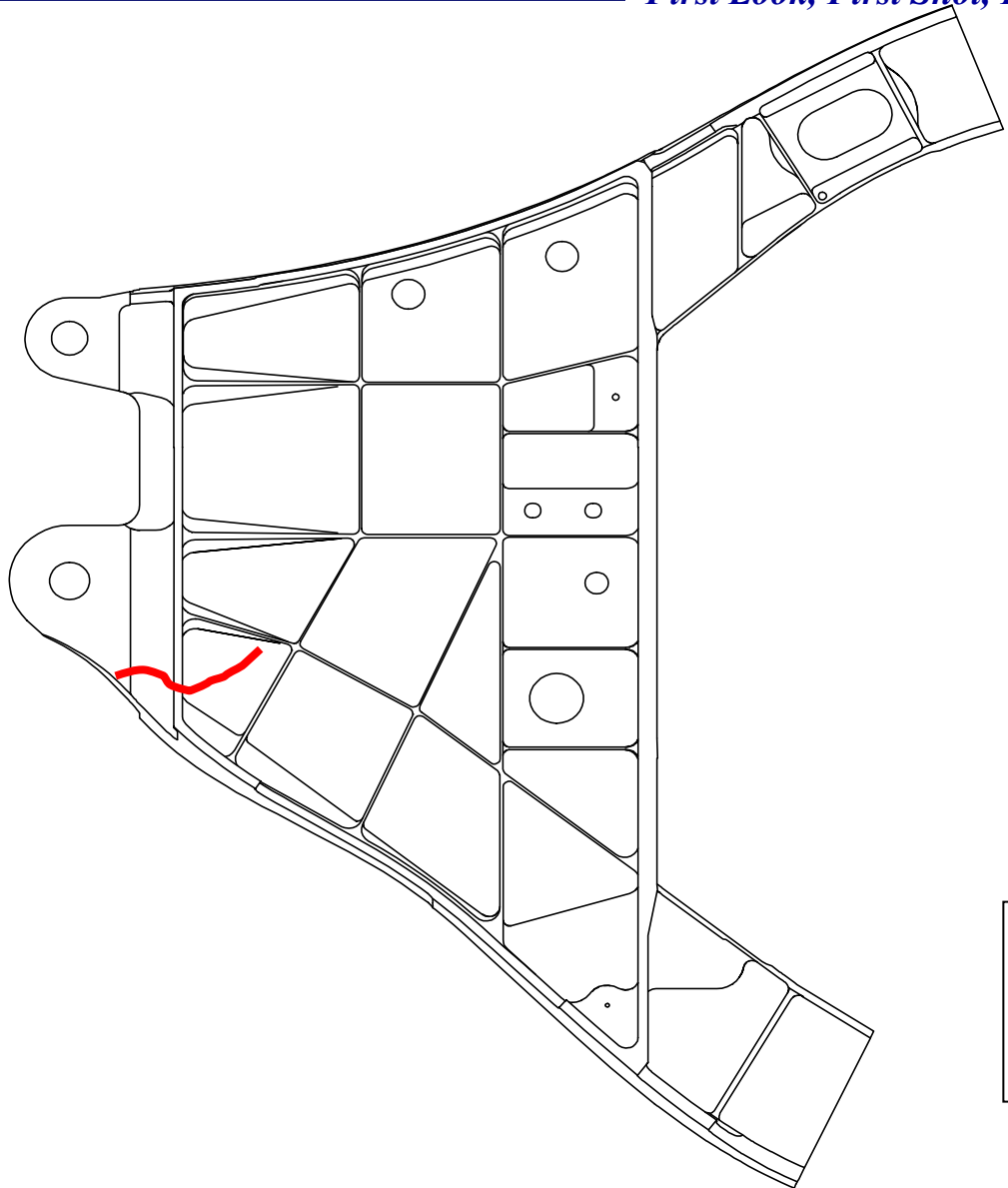
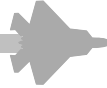

The crack wraps around the lug to the thickened up area ending at a thin section



Fwd Boom & Engine Bay Structure



First Look, First Shot, First Kill!

F/A-22 

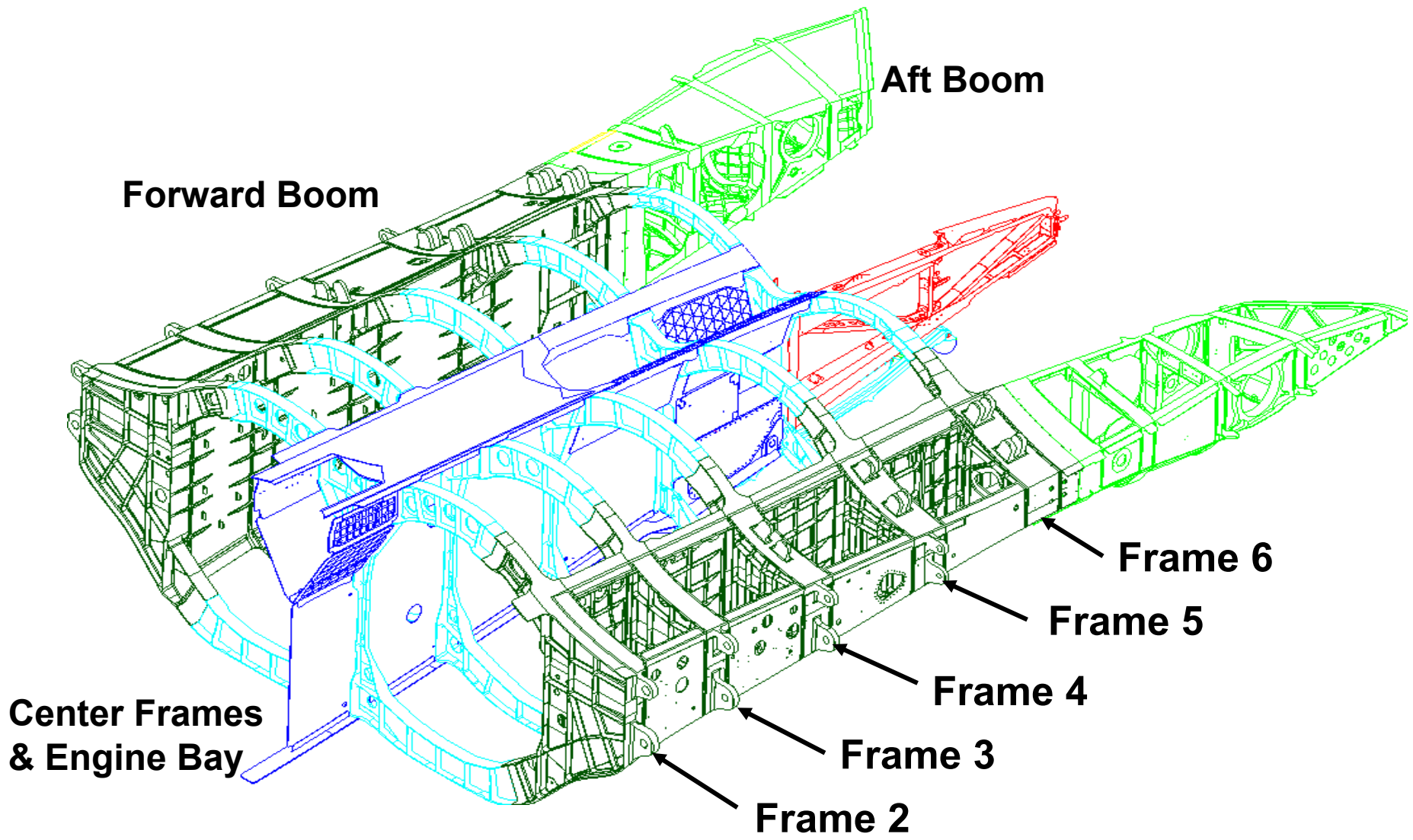



Crack Locations Identified



First Look, First Shot, First Kill!



FS 657 Frame 2

LHS ← | → RHS

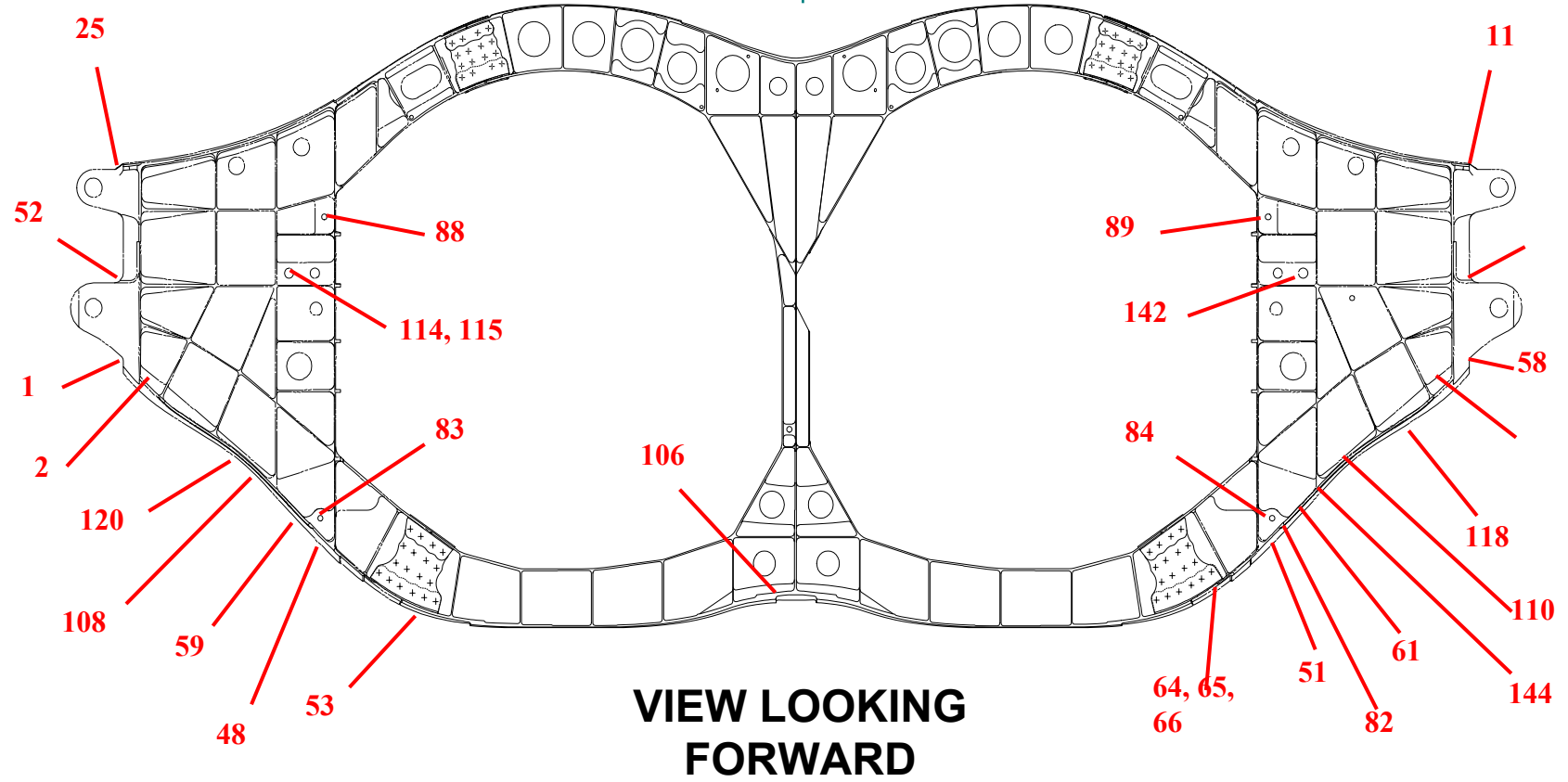



Crack Locations Identified



First Look, First Shot, First Kill!



FS 583 **90** FS 610 FS 657 FS 681 FS 708

RHS Wing

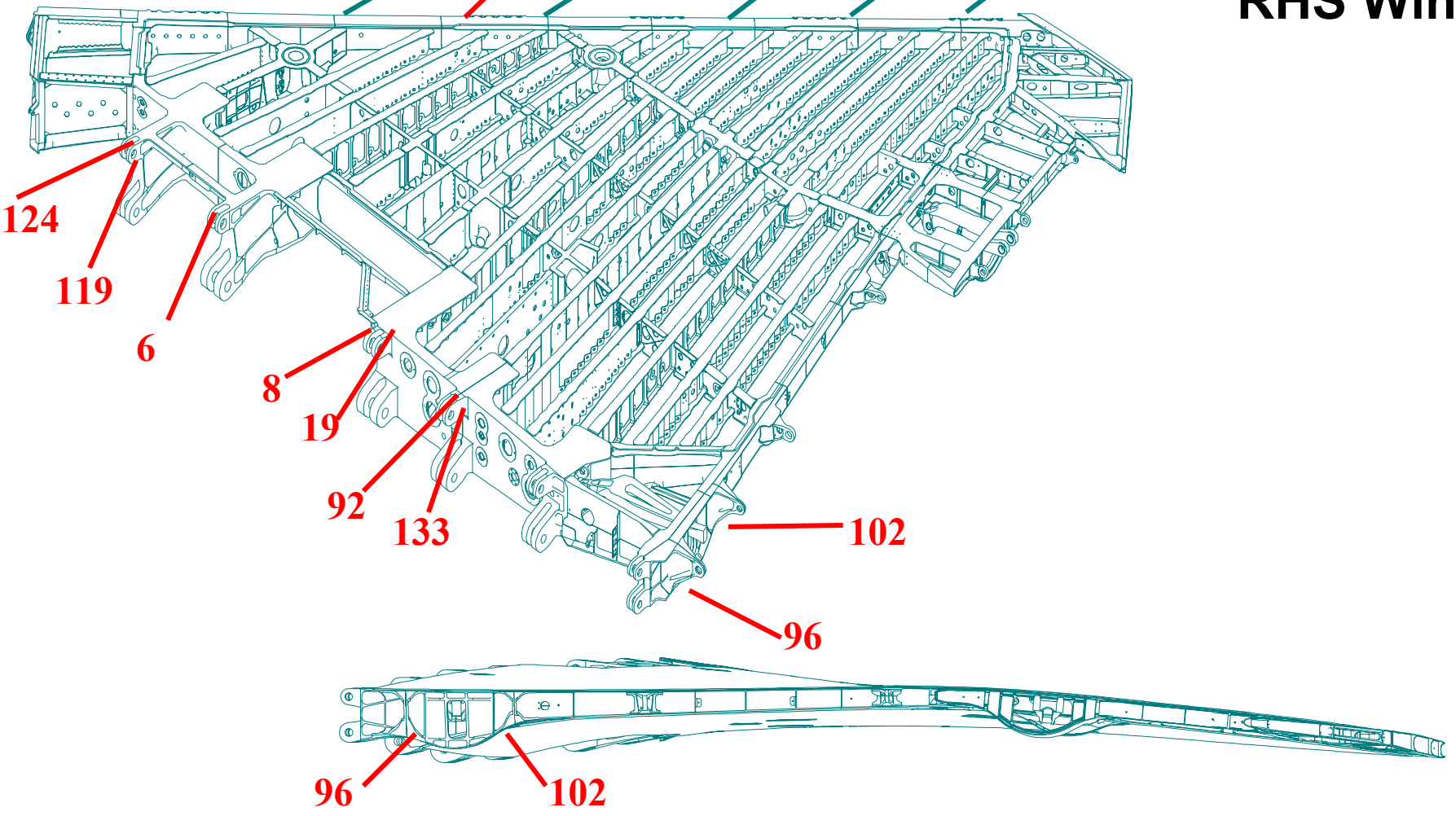



Crack Locations Identified



First Look, First Shot, First Kill!



Aft Booms

ISO View

RHS

LHS

FWD

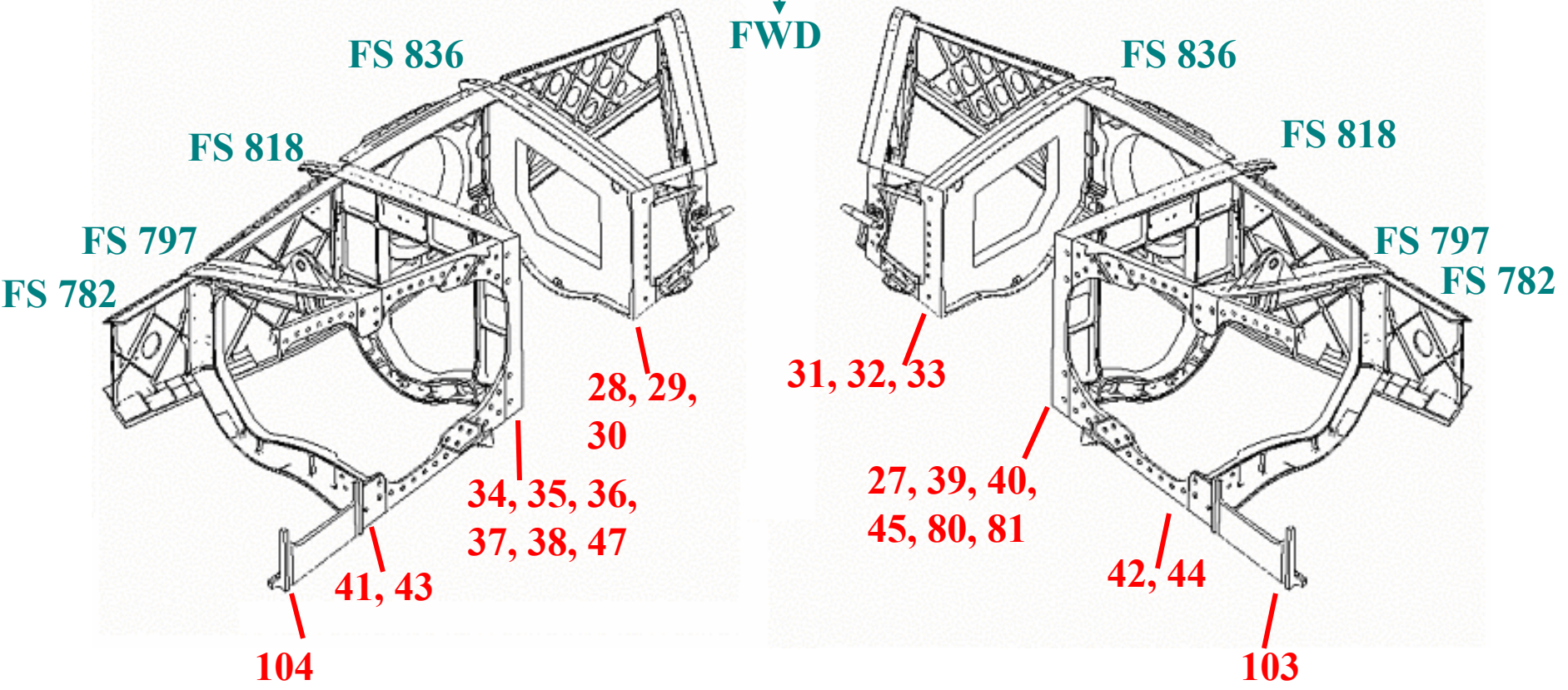



Major Cracking Events



First Look, First Shot, First Kill!

F/A-22



- **Aft boom frames**
- **Forward boom frame lugs**
- **Forward boom flange/web fastener holes**
- **Inboard wing rear spar**
- **Main Weapon Bay Door hinge**



Repairs



First Look, First Shot, First Kill!

F/A-22



- **Aft boom frame doublers**
- **Aft boom patch**
- **Forward boom lug weld (non-fleet representative)**
- **Main Weapon Bay door hinge replacement with redesigned part**



Aft Boom Frame 4 Repair



First Look, First Shot, First Kill!

F/A-22 →

Crack locations

Secondary shear plate

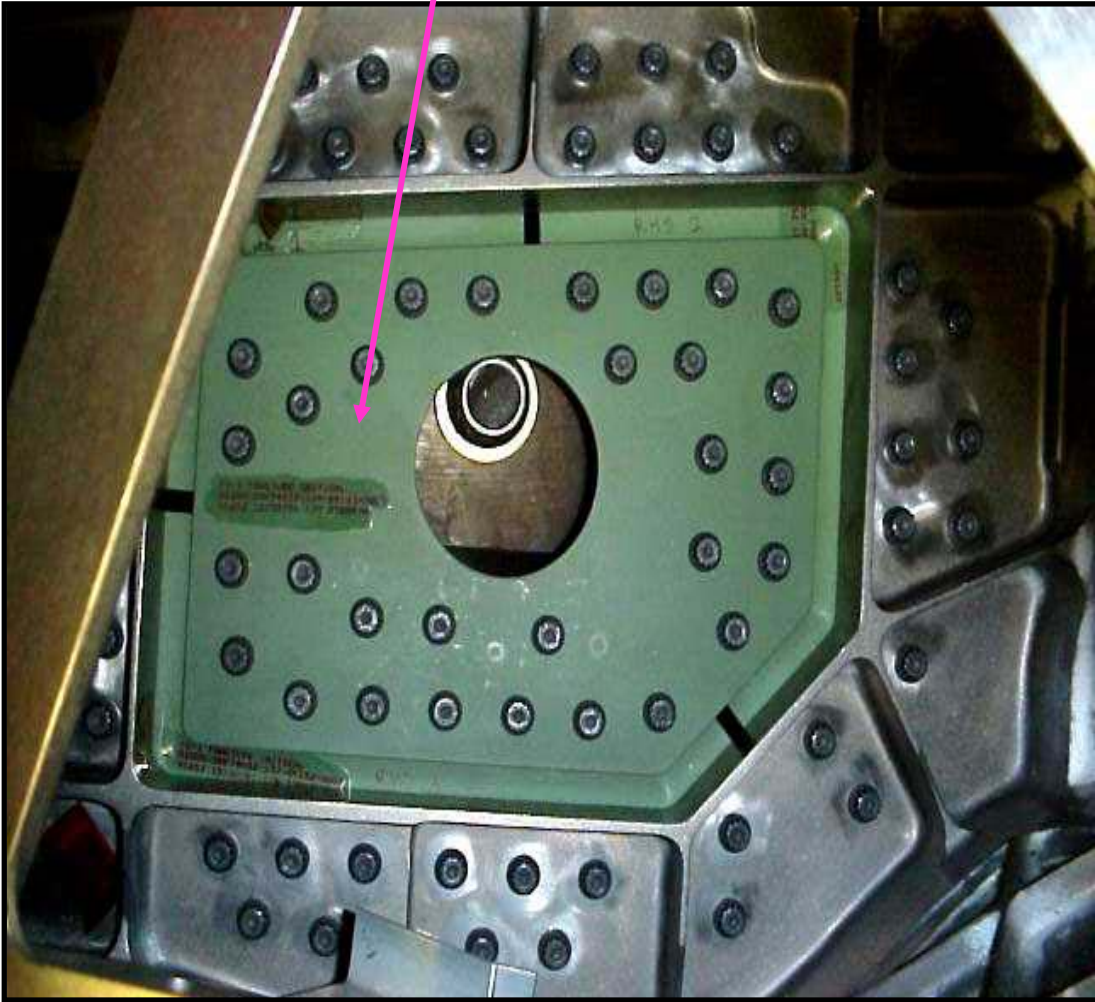
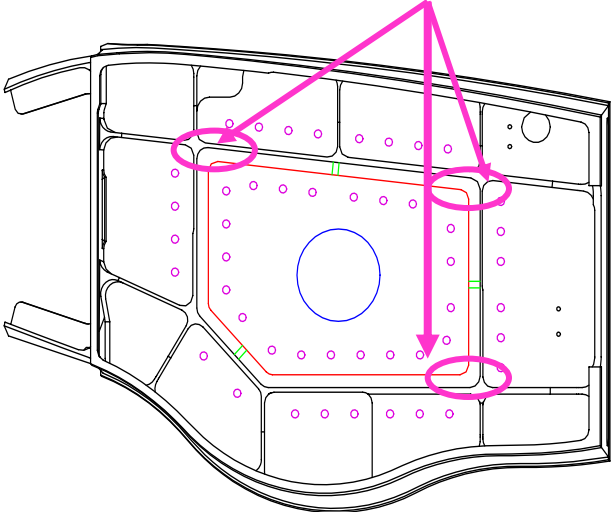

Looking Forward

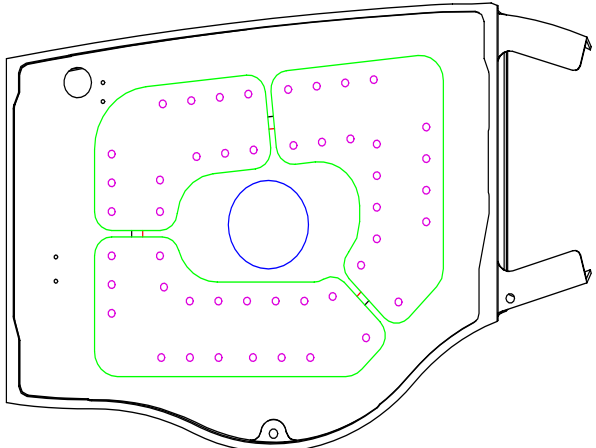

Looking Aft



Aft Boom



First Look, First Shot, First Kill!

F/A-22

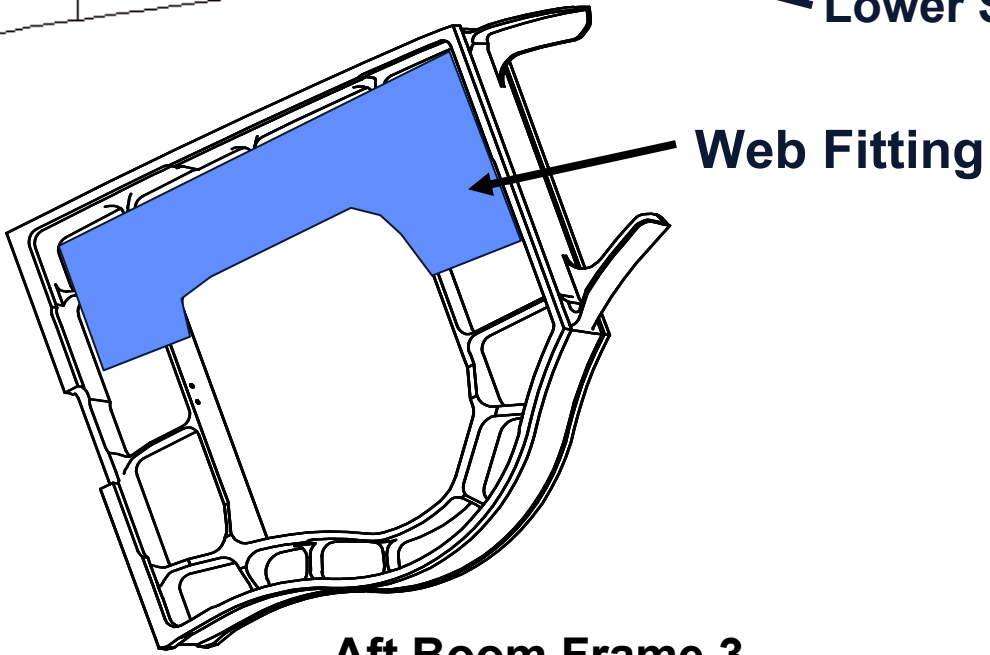
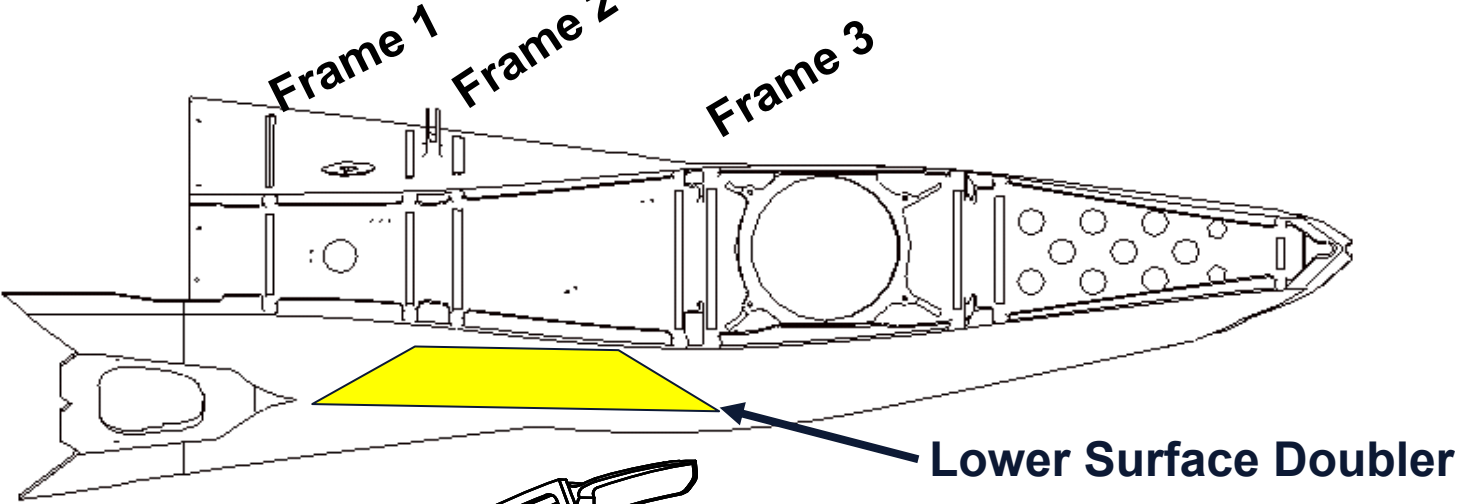



FS 681 LHS Fwd Boom, A1 Tank, Web



First Look, First Shot, First Kill!

F/A-22 →

Gusset (fleet representative)

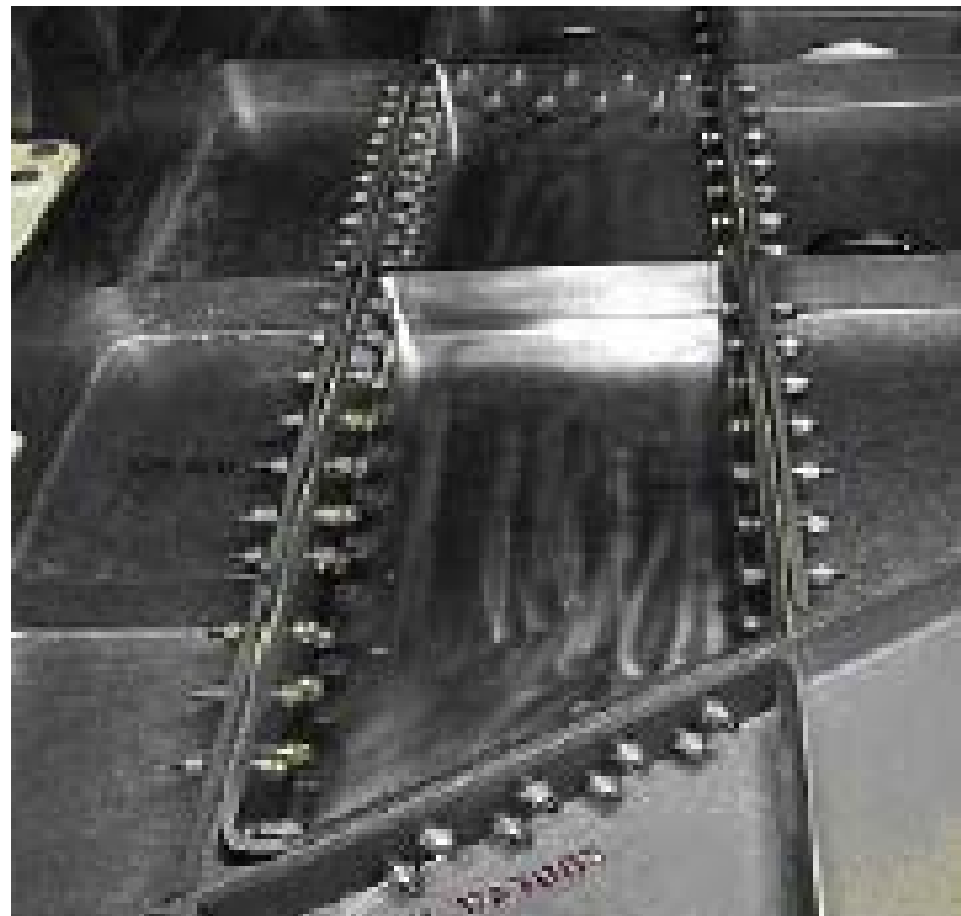
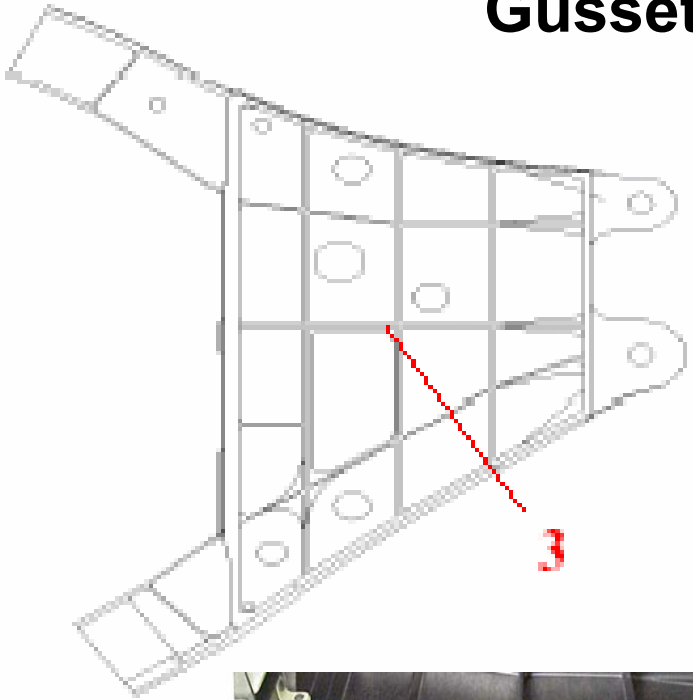



Mid Fuselage Structure



First Look, First Shot, First Kill!

F/A-22 →

- **Main Weapon Bay Door Hinge Fitting @ FS 583**
 - Replaced Aluminum configuration with redesigned Titanium hinge fitting

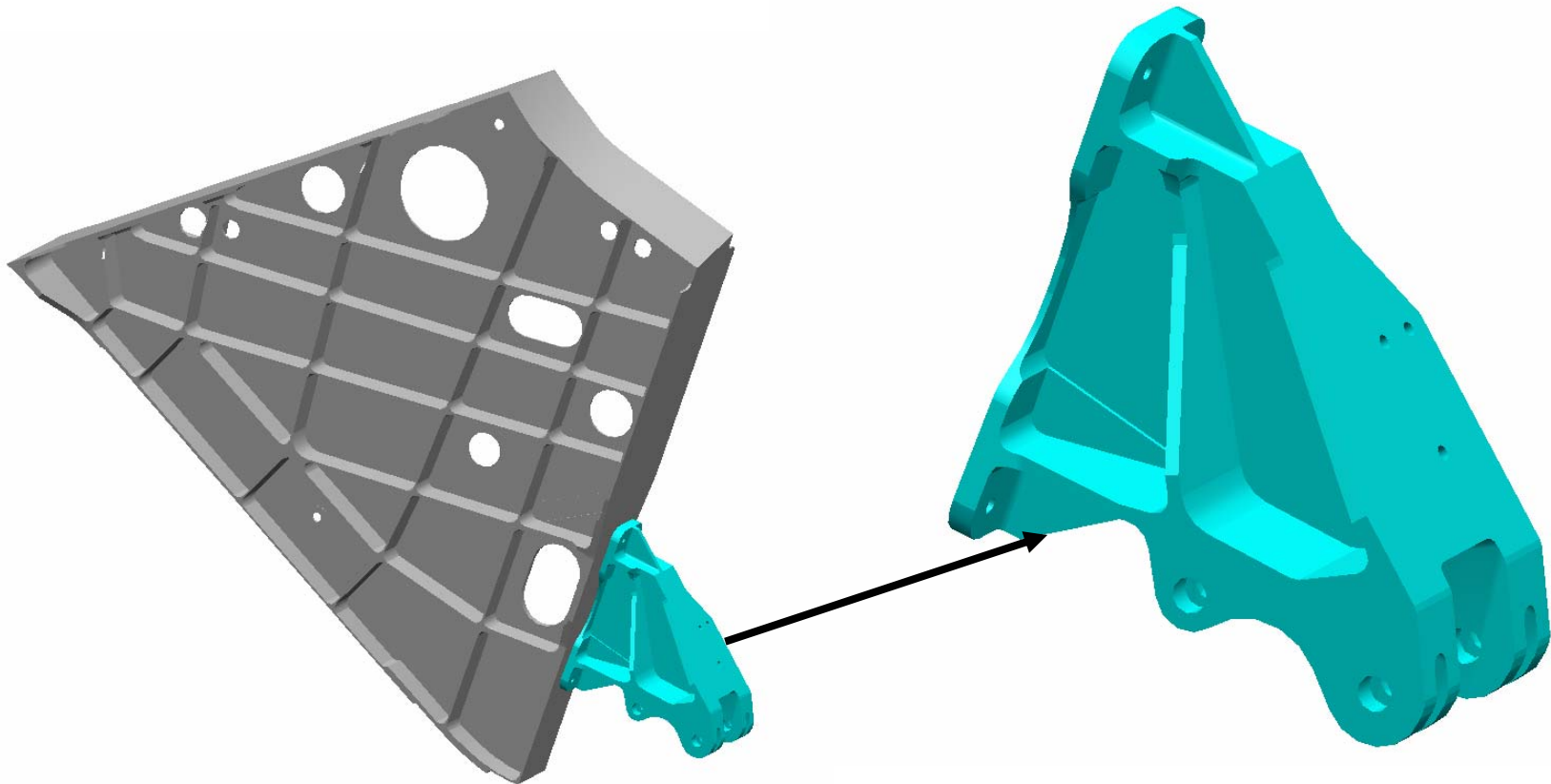



A/C 4000 Repair Downtime



First Look, First Shot, First Kill!



Downtime for fleet representative structural repair only

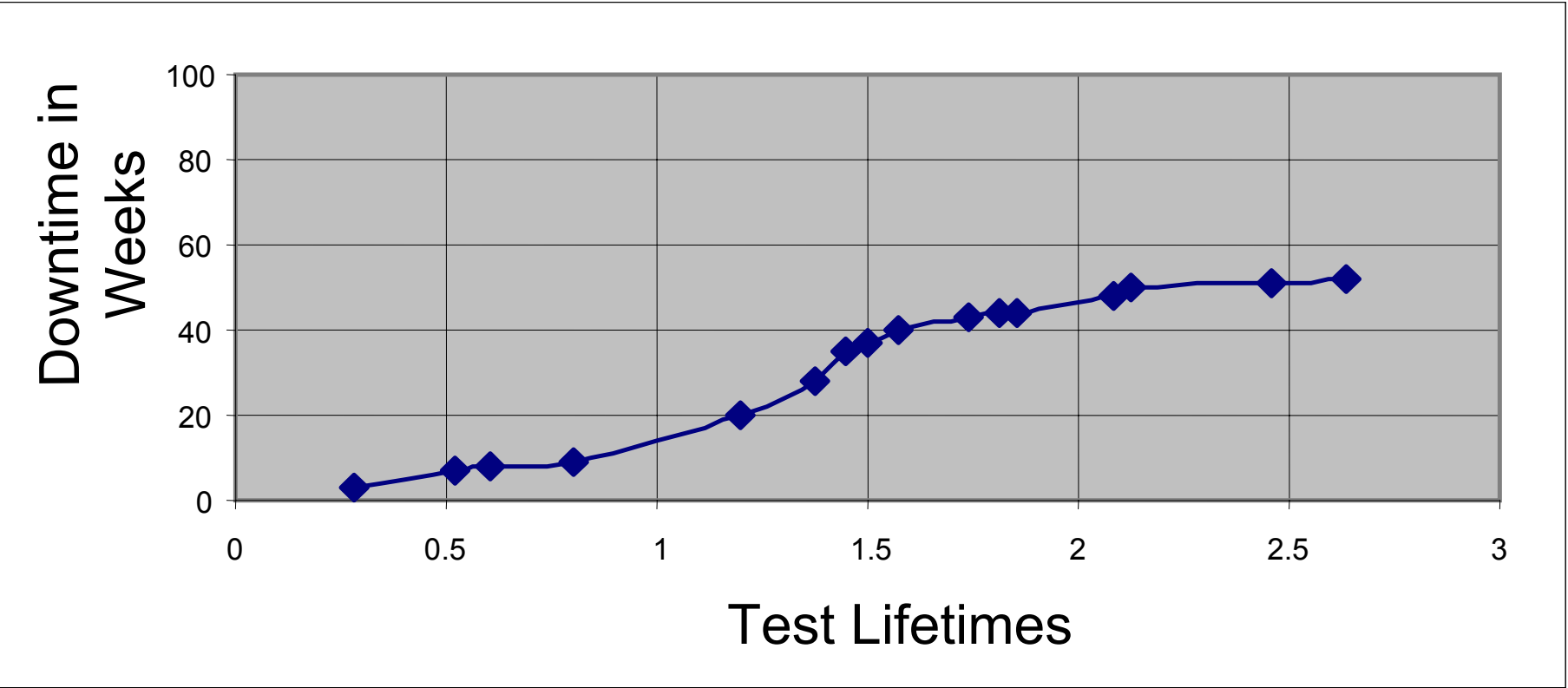



Historical Experience



First Look, First Shot, First Kill!

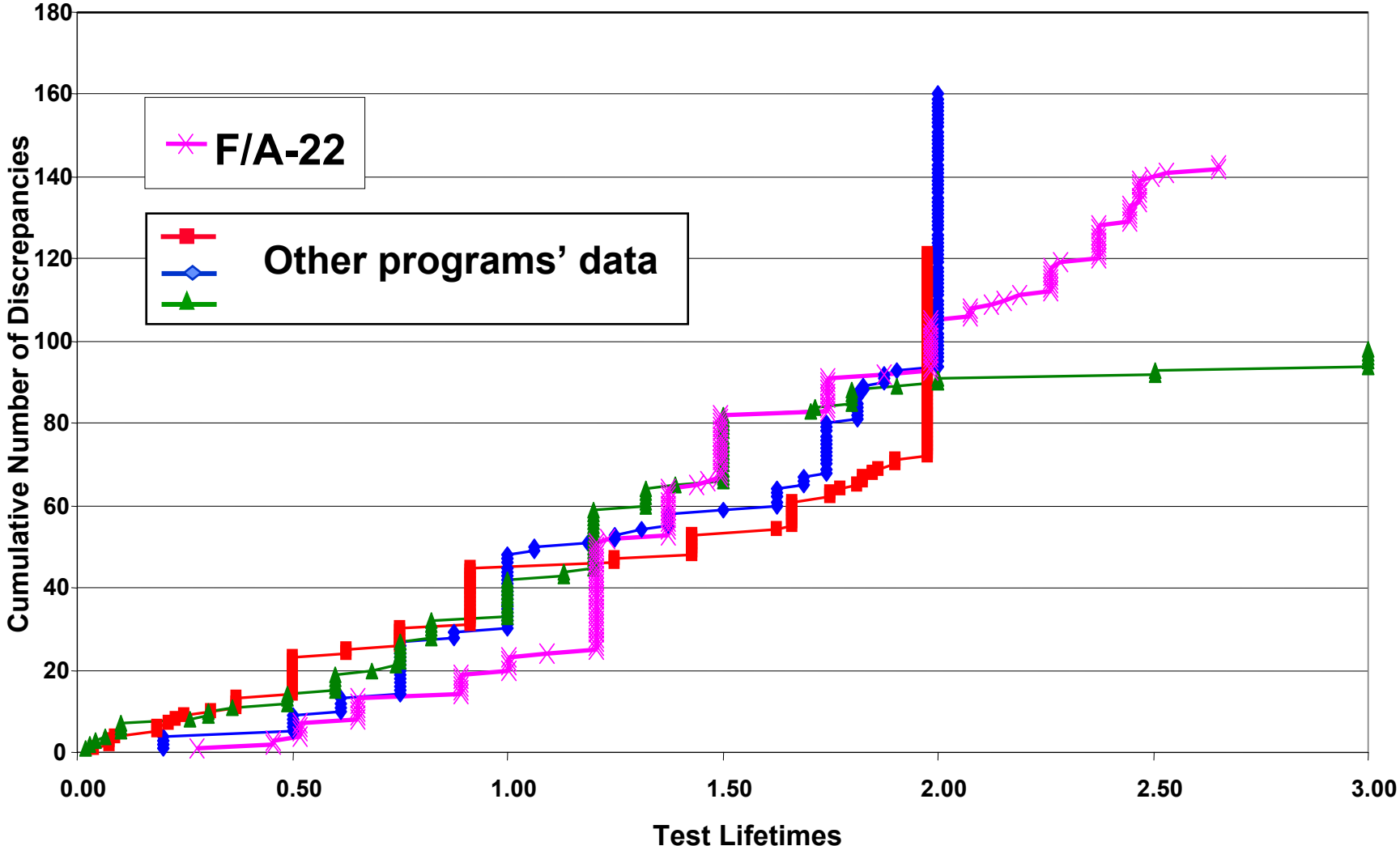



Test Anomaly Process



First Look, First Shot, First Kill!

F/A-22 

- Every anomaly initiates a Test Anomaly Report (TAR)

| | |
|---------------------|---|
| Section 1.0: | Description & history of anomaly |
| Section 2.1: | Investigation (includes initial correlation summary) |
| Section 2.2: | Conclusions |
| Section 2.3: | Recommended resolution |
| Section 3.0: | Resolution (retrofit/redesign/inspection update) |

- TAR also includes embedded or attached files
 - Fleet inspection requirement authorizations
 - Redesign or Retrofit memos
 - EMD aircraft inspection results if appropriate
 - Test article inspection/lab results
 - Fractography results

One-stop Shopping For All Test Anomaly Information



F/A-22 Structural Redesigns



First Look, First Shot, First Kill!



Strength & Life Issues

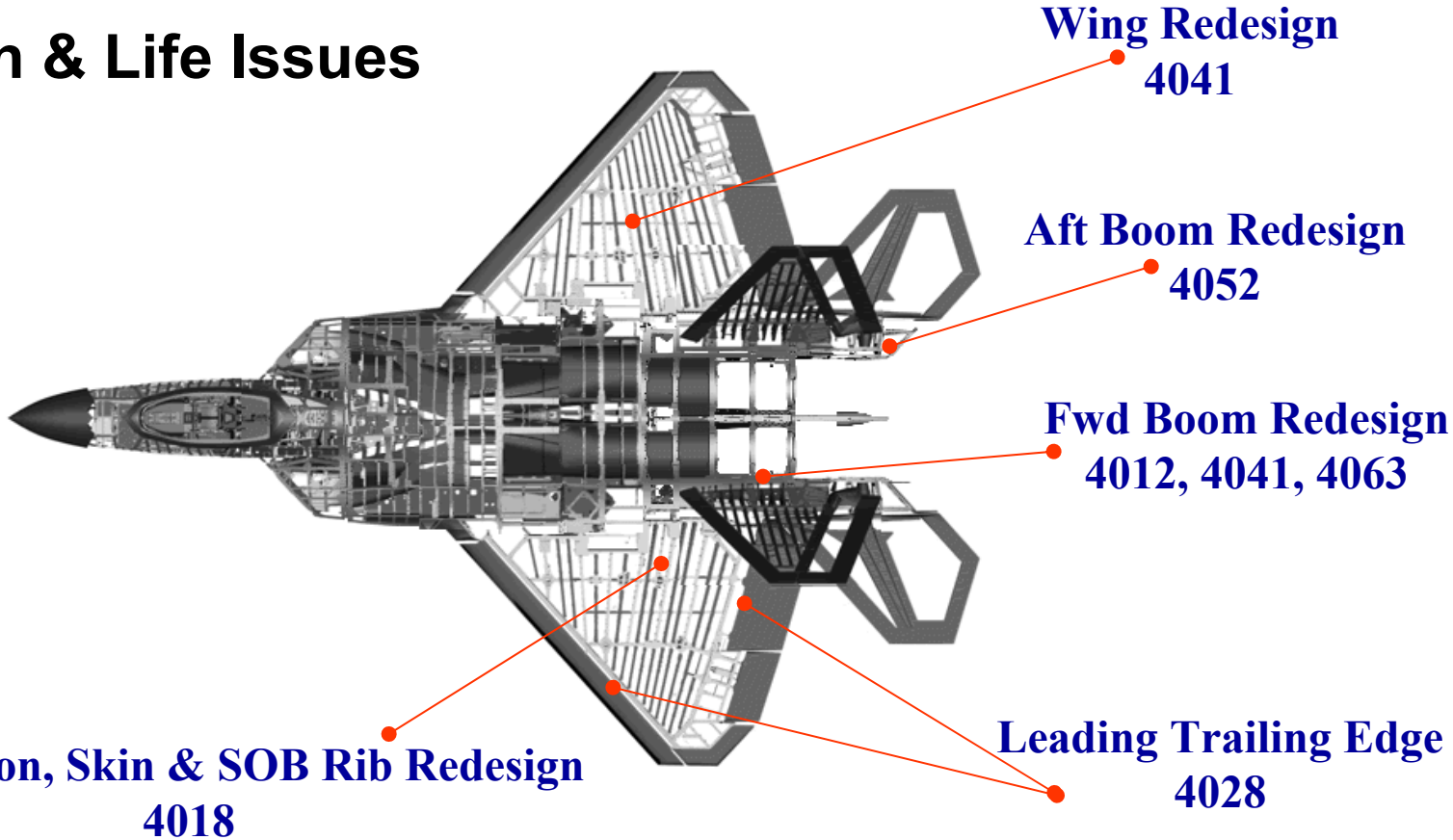



Test Completion



First Look, First Shot, First Kill!

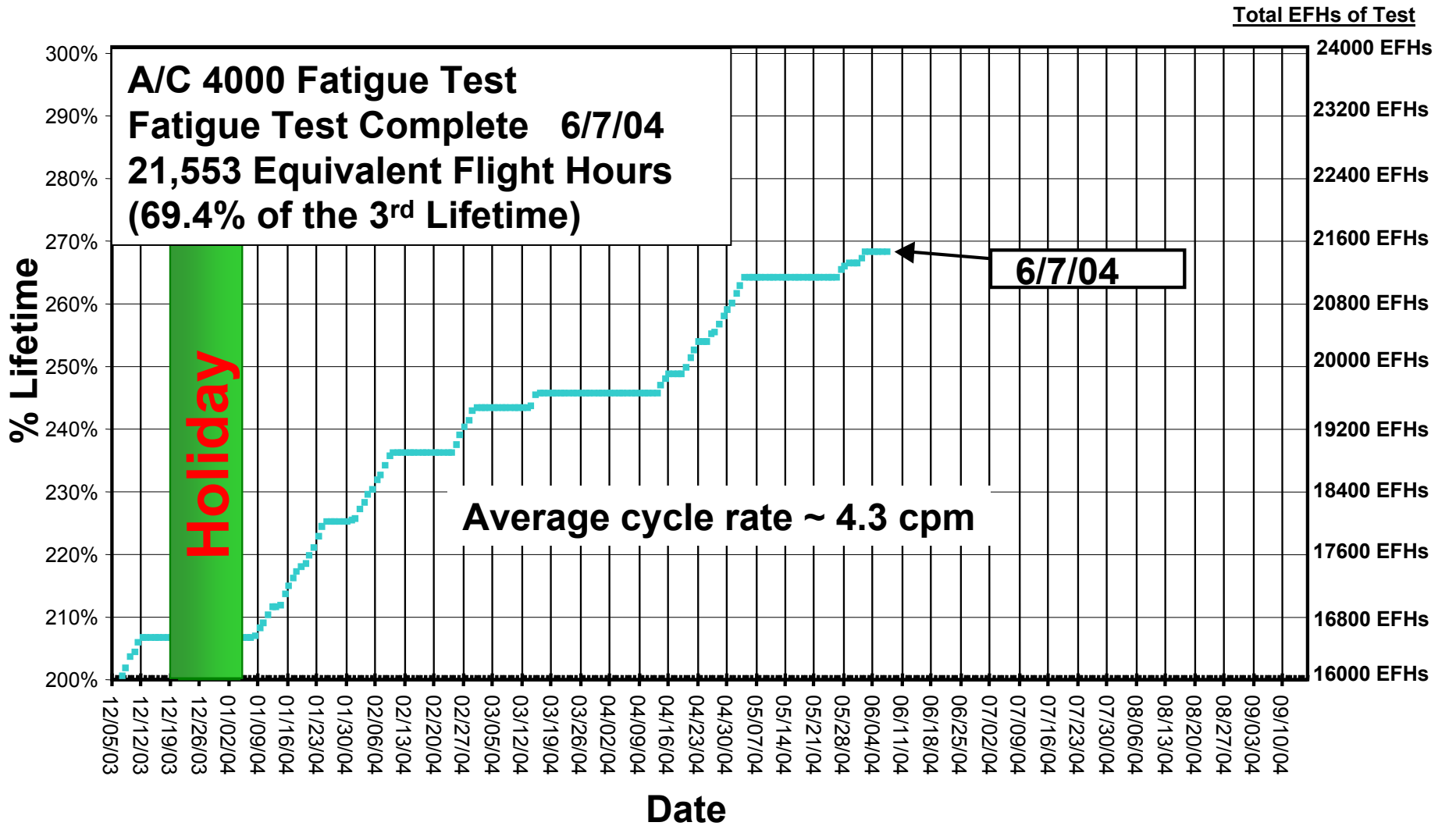



Conclusion



First Look, First Shot, First Kill!



- F/A-22 fatigue test was designed, planned and instrumented to verify the durability of the airframe
- Through the Test Anomaly Report process, test results have influenced several actions
 - Redesigns
 - Inspection requirement updates
 - Full-Scale component tests
 - › Horizontal Tail
 - › Aft Boom
 - Structures Retrofit Plan for a/c 4010-62
- With scheduled NDI inspections, daily diagnostic monitoring of gage data, and repairs as needed, the test article achieved 2.68 lifetimes without catastrophic failure

Teardown is in progress



Questions?

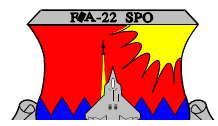

First Look, First Shot, First Kill!

F/A-22

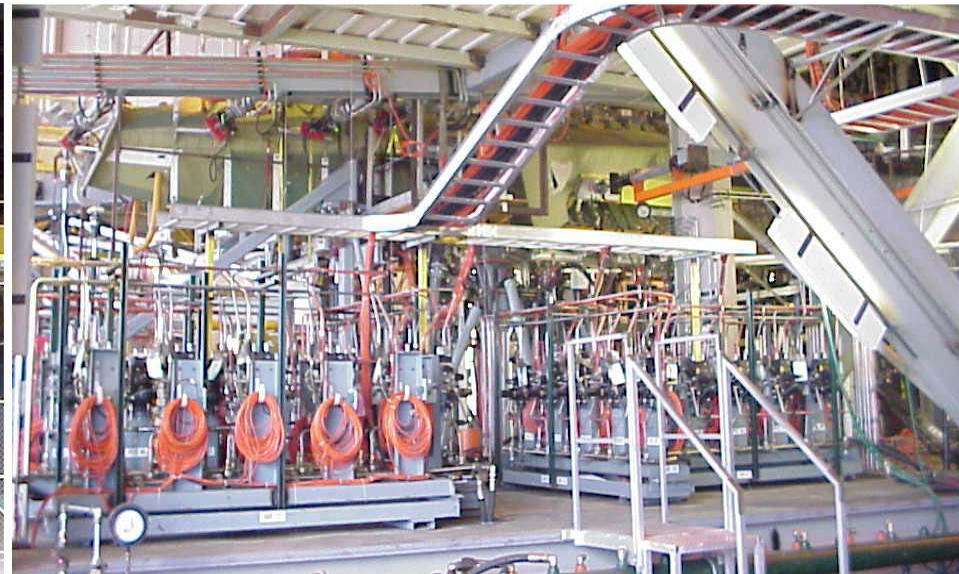
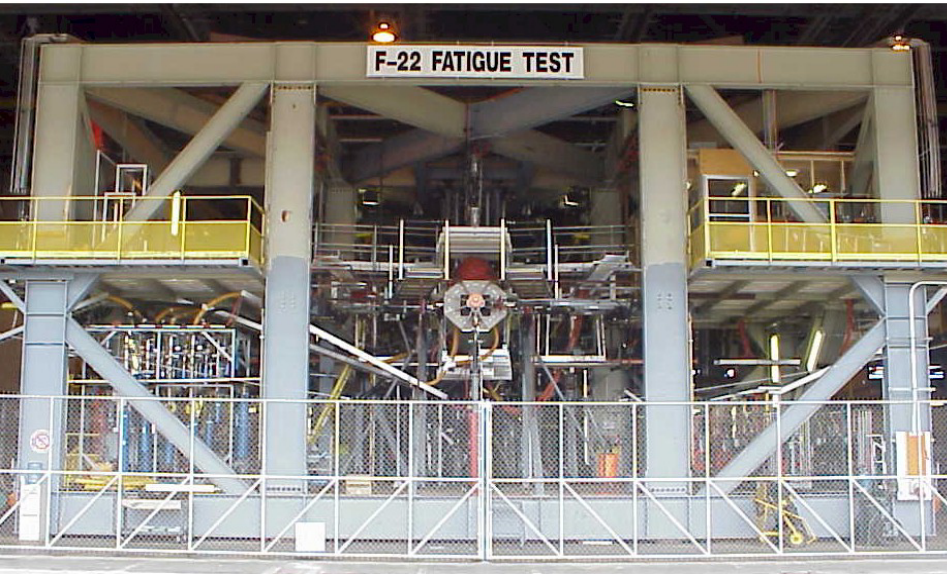

F/A-22 Team Members Supporting Full Scale Fatigue Test:
Boeing DADT Engineering
LM Aero-Fort Worth DADT Engineering
LM Aero-Marietta DADT & Ground Test Engineering
LM Aero-Marietta Structural Test Engineering